



RESIDENTIAL ESTATE AGENTS  
PROPERTY LETTING & MANAGING AGENTS  
VALUERS & PROPERTY CONSULTANTS  
CHARTERED SURVEYORS

**01722 336422**  
[www.hwwhite.co.uk](http://www.hwwhite.co.uk) WEB



**Pilgrims Way, Laverstock**

**£1,350 PCM**

**37 Pilgrims Way, Laverstock, Salisbury, Wiltshire, SP1 1RZ**

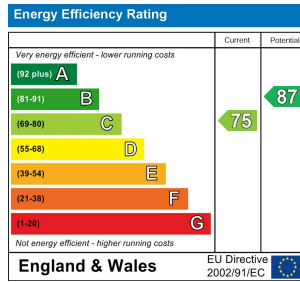

A 3 bed terraced house situated opposite the park within an established residential development. The accommodation comprises entrance hall with ground floor WC, a fitted kitchen with gas hob, single electric oven, space for washing machine and dishwasher, spacious sitting/dining room with french doors to garden. Upstairs there is a master bedroom, en-suite shower room, double bedroom 2 and bedroom 3. Family bathroom with shower over bath. Enclosed rear garden with new decking area, sloping lawn and paved path to pedestrian gate leading to parking/garage. The garage has been converted to provide self-contained office at the rear with useful storage/shelving to the front, behind electric roller door. Parking space in front of the garage. The property has double glazed windows throughout and gas boiler for central heating and hot water. Available UNFURNISHED potentially long term.

#### Description

A 3 bed terraced house situated opposite the park within an established residential development. The accommodation comprises entrance hall with ground floor WC, a fitted kitchen with gas hob, single electric oven, space for washing machine and dishwasher, spacious sitting/dining room with french doors to garden. Upstairs there is a master bedroom, en-suite shower room, double bedroom 2 and bedroom 3. Family bathroom with shower over bath. Enclosed rear garden with new decking area, sloping lawn and paved path to pedestrian gate leading to parking/garage. The garage has been converted to provide self-contained office at the rear with useful storage/shelving to the front, behind electric roller door. Parking space in front of the garage. The property has double glazed windows throughout and gas boiler for central heating and hot water. Available UNFURNISHED potentially long term.

#### A Note From the Whites Letting Team

Thank you for considering Whites as your letting agent. As a proud member of the Royal Institution of Chartered Surveyors (RICS), we aspire to uphold its core values by providing a fair, efficient, and transparent service for all prospective tenants. Below we've outlined how we manage property enquiries and applications to help set expectations and guide you through the letting application process.

To begin the process of enquiring about one of our properties, please click the 'Request Further Details/Info' button on the property listing. This will send us your contact information, and we'll get back to you as soon as possible with a short questionnaire to complete. Once we've received your completed questionnaire, your enquiry will be registered with the relevant Property Manager. Please note, only those who complete this step will be considered as having formally enquired about the property.

Due to the high level of interest we often receive, we regret that we aren't often able to offer everyone a viewing. Where possible, we handle enquiries in the order they are received and arrange viewings in groups of up to 4 for the first update

Please  
landlord

The avc

#### Ground Floor

Approx. 39.6 sq. metres (426.8 sq. feet)

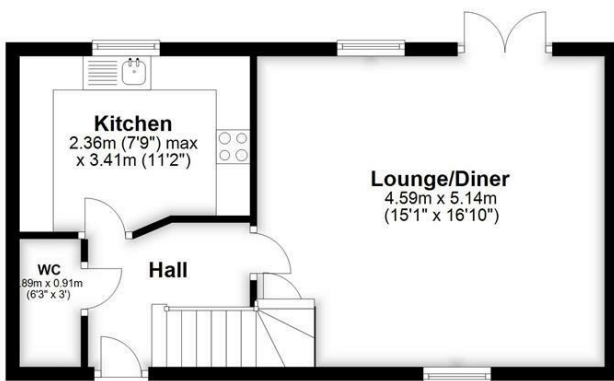

#### First Floor

Approx. 39.6 sq. metres (426.8 sq. feet)

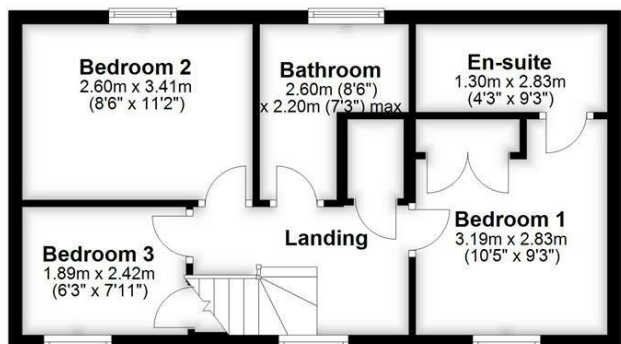

Total area: approx. 79.3 sq. metres (853.6 sq. feet)



01722 336422

47 Castle Street, Salisbury SP1 3SP 01722 320600 FAX  
residential-sales@hwwhite.co.uk E-MAIL www.hwwhite.co.uk WEB